

**REGIONAL TOWN PLANNING AREA  
PARCELLATION SCHEME N<sup>o</sup> R/99.**

**JALIL EL QIBLIYA ~ BLOCK 6605 - PARCEL 2; BLOCK 6606 - PARCELS 2,3,6; BLOCK 6608 - PARCEL 1. ~ PREP. FOR MR. M. MATALON & MR. M. CARASSO**

SCALE 1:2500

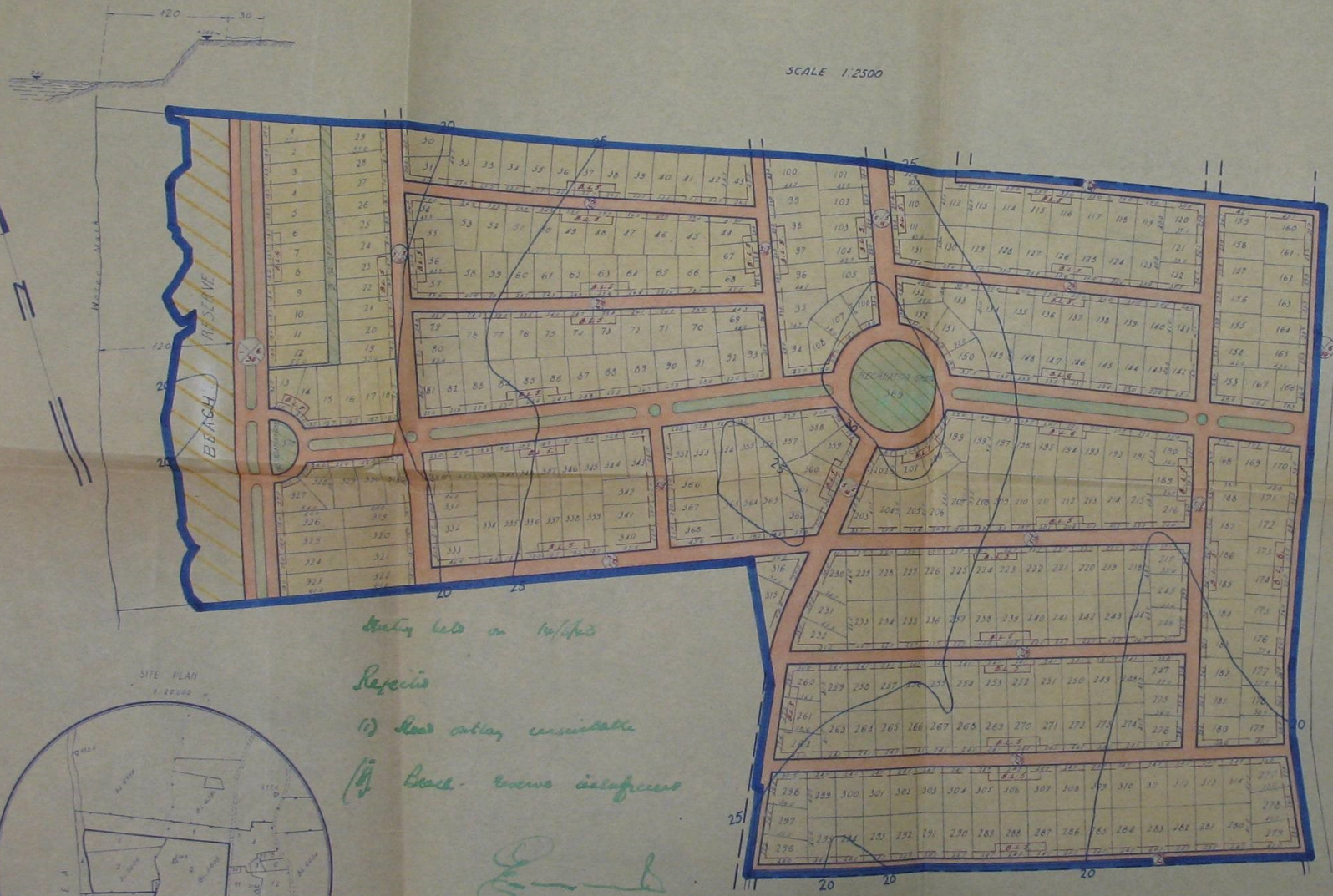

LOT NO.	AREA IN SQ. M.	FLOOR AREA IN SQ. M.	LOT NO.	AREA IN SQ. M.	FLOOR AREA IN SQ. M.	LOT NO.	AREA IN SQ. M.	FLOOR AREA IN SQ. M.				
1	1000	59	1007	107	1000	160	1000	213	1000	266	1000	319
2	1000	55	1008	108	1000	161	1000	214	1000	267	1000	320
3	1000	56	1009	109	1000	162	1000	215	1000	268	1000	321
4	1000	57	1010	110	1000	163	1000	216	1000	269	1000	322
5	1000	58	1011	111	1000	164	1000	217	1000	270	1000	323
6	1000	59	1012	112	1040	165	1000	218	1005	271	1000	324
7	1000	60	1013	113	1000	166	1000	219	1000	272	1000	325
8	1000	61	1014	114	1000	167	1000	220	1000	273	1000	326
9	1000	62	1015	115	1000	168	1000	221	1000	274	1000	327
10	1000	63	1016	116	1000	169	1000	222	1000	275	1000	328
11	1000	64	1017	117	1000	170	1005	223	1000	276	1000	329
12	1000	65	1018	118	1000	171	1005	224	1000	277	1000	330
13	1010	66	1019	119	1000	172	1004	225	1000	278	1000	331
14	1010	67	1020	120	1000	173	1004	226	1000	279	1000	332
15	1000	68	1021	121	1000	174	1000	227	1000	280	1000	333
16	1000	69	1022	122	1000	175	1000	228	1000	281	1000	334
17	1000	70	1023	123	1000	176	1005	229	1000	282	1000	335
18	1000	71	1024	124	1000	177	1005	230	1000	283	1000	336
19	1010	72	1025	125	1000	178	1005	231	1000	284	1000	337
20	1010	73	1026	126	1000	179	1015	232	1000	285	1000	338
21	1010	74	1027	127	1000	180	1005	233	1000	286	1000	339
22	1010	75	1028	128	1000	181	1005	234	1000	287	1000	340
23	1010	76	1029	129	1000	182	1005	235	1000	288	1000	341
24	1010	77	1030	130	1000	183	1000	236	1000	289	1000	342
25	1010	78	1031	131	1000	184	1000	237	1000	290	1000	343
26	1010	79	1032	132	1010	185	1000	238	1000	291	1000	344
27	1010	80	1033	133	1000	186	1000	239	1000	292	1000	345
28	1010	81	1034	134	1020	187	1005	240	1000	293	1000	346
29	1210	82	1035	135	1020	188	1005	241	1000	294	1000	347
30	1000	83	1036	136	1020	189	1010	242	1000	295	1000	348
31	1000	84	1037	137	1020	190	1015	243	1000	296	1000	349
32	1000	85	1038	138	1020	191	1000	244	1000	297	1000	350
33	1000	86	1039	139	1020	192	1000	245	1000	298	1000	351
34	1000	87	1040	140	1020	193	1000	246	1000	299	1000	352
35	1000	88	1041	141	1020	194	1000	247	1000	300	1000	353
36	1000	89	1042	142	1025	195	1000	248	1000	301	1000	354
37	1000	90	1043	143	1020	196	1000	249	1000	302	1000	355
38	1000	91	1044	144	1010	197	1000	250	1000	303	1000	356
39	1000	92	1045	145	1008	198	1000	251	1000	304	1000	357
40	1000	93	1046	146	1005	199	1010	252	1000	305	1000	358
41	1000	94	1047	147	1010	200	1000	253	1000	306	1000	359
42	1000	95	1048	148	1005	201	1000	254	1000	307	1000	360
43	1000	96	1049	149	1005	202	1000	255	1000	308	1000	361
44	1000	97	1050	150	1005	203	1000	256	1000	309	1000	362
45	1000	98	1051	151	1005	204	1000	257	1000	310	1000	363
46	1000	99	1052	152	1010	205	1000	258	1000	311	1000	364
47	1000	100	1053	153	1000	206	1000	259	1000	312	1000	365
48	1000	101	1054	154	1000	207	1000	260	1000	313	1000	366
49	1000	102	1055	155	1000	208	1000	261	1000	314	1000	367
50	1000	103	1056	156	1000	209	1000	262	1000	315	1000	368
51	1000	104	1057	157	1000	210	1000	263	1000	316	1000	369
52	1000	105	1058	158	1000	211	1000	264	1000	317	1000	370
53	1000	106	1059	159	1000	212	1000	265	1000	318	1045	371

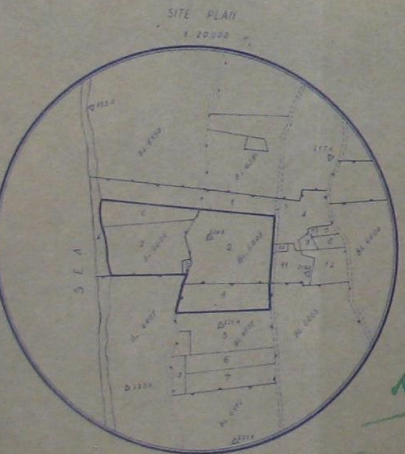

*Handwritten notes:*  
 duty led on 10/1/05  
 Report  
 (i) Road overlay essential  
 (ii) Beach reserve insufficient  
 10/1/05

**NOTE**  
 Commission has ordered that certain parcellation schemes in area between S. boundary of Hattaba Sub. & the Spanish land to not be included with a detailed scheme for this area has been previously approved.

**LEGEND:**

BOUNDARY W. P.O.	[Blue line]
SEA	[Blue area]
REGISTRATION OFFICE	[Green circle]
ROAD	[Orange line]
RESIDENTIAL ZONE A	[Yellow area]
RESIDENTIAL ZONE B	[Light yellow area]
BEACH RESERVE	[Hatched area]
REGISTRATION OFFICE	[Green circle]
REGISTRATION OFFICE	[Green circle]